

## Parallel Bar Manifolds

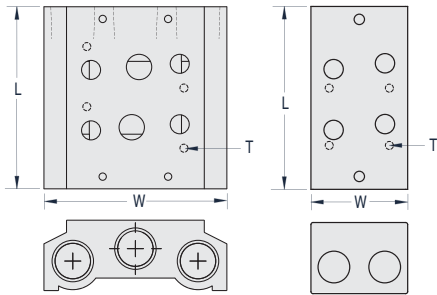

4-Way Manifold

3-Way Manifold



Valve Series	2-Station	4-Station	6-Station	8-Station	16-Station	"T" Mtg. Thread
MMA-31/41	2.24 (56.9)	3.73 (94.7)	5.25 (133.4)	6.75 (171.5)	12.69 (322.3)	M4
MMA-32/42	2.71 (68.8)	4.50 (114.3)	6.33 (160.8)	8.13 (206.5)	15.38 (390.7)	M4
MMA-33/43	3.22 (81.8)	5.42 (137.7)	7.62 (193.5)	9.82 (249.4)	18.63 (473.2)	M5
MMA-34/44	3.85 (97.8)	6.56 (166.6)	9.38 (238.3)	12.10 (307.3)	23.11 (587.0)	M5

Parallel circuit manifold bars are available for all sizes of MMA 3- and 4-way valves. **Manifolds are made in increments of two stations from two to 16**, and are supplied with mounting screws and gaskets. Spare kits are also available which include two screws and a gasket. Blank plate supplied with one gasket, two screws and metal plate.

Valve Series	Manifold Inlet/ Exhaust	Blank Plate	2-Station	4-Station	6-Station	8-Station	16-Station
<b>3-Way Valve Manifolds</b>							
MMA-31	1/8"	<a href="#">MMM-31-B</a>	<a href="#">MMM-31-02</a>	<a href="#">MMM-31-04</a>	<a href="#">MMM-31-06</a>	<a href="#">MMM-31-08</a>	<a href="#">MMM-31-16</a>
MMA-32	1/4"	<a href="#">MMM-32-B</a>	<a href="#">MMM-32-02</a>	<a href="#">MMM-32-04</a>	<a href="#">MMM-32-06</a>	<a href="#">MMM-32-08</a>	<a href="#">MMM-32-16</a>
MMA-33	3/8"	<a href="#">MMM-33-B</a>	<a href="#">MMM-33-02</a>	<a href="#">MMM-33-04</a>	<a href="#">MMM-33-06</a>	<a href="#">MMM-33-08</a>	<a href="#">MMM-33-16</a>
MMA-34	1/2"	<a href="#">MMM-34-B</a>	<a href="#">MMM-34-02</a>	<a href="#">MMM-34-04</a>	<a href="#">MMM-34-06</a>	<a href="#">MMM-34-08</a>	<a href="#">MMM-34-16</a>

### 3-Way Spare Mounting Kit Hardware

[27041-31](#) . . . . . Hardware Kit for MMA-31 Series Valves

[27041-33](#) . . . . . Hardware Kit for MMA-33 Series Valves

[27041-32](#) . . . . . Hardware Kit for MMA-32 Series Valves

[27041-34](#) . . . . . Hardware Kit for MMA-34 Series Valves

Valve Series	Manifold Inlet/ Exhaust	Blank Plate	2-Station	4-Station	6-Station	8-Station	16-Station
<b>4-Way Valve Manifolds</b>							
MMA-41	1/4"	<a href="#">MMM-41-B</a>	<a href="#">MMM-41-02</a>	<a href="#">MMM-41-04</a>	<a href="#">MMM-41-06</a>	<a href="#">MMM-41-08</a>	<a href="#">MMM-41-16</a>
MMA-42	1/4"	<a href="#">MMM-42-B</a>	<a href="#">MMM-42-02</a>	<a href="#">MMM-42-04</a>	<a href="#">MMM-42-06</a>	<a href="#">MMM-42-08</a>	<a href="#">MMM-42-16</a>
MMA-43	3/8"	<a href="#">MMM-43-B</a>	<a href="#">MMM-43-02</a>	<a href="#">MMM-43-04</a>	<a href="#">MMM-43-06</a>	<a href="#">MMM-43-08</a>	<a href="#">MMM-43-16</a>
MMA-44	1/2"	<a href="#">MMM-44-B</a>	<a href="#">MMM-44-02</a>	<a href="#">MMM-44-04</a>	<a href="#">MMM-44-06</a>	<a href="#">MMM-44-08</a>	<a href="#">MMM-44-16</a>

### 4-Way Spare Mounting Kit Hardware

[27041-41](#) . . . . . Hardware Kit for MMA-41 Series Valves

[27041-43](#) . . . . . Hardware Kit for MMA-43 Series Valves

[27041-42](#) . . . . . Hardware Kit for MMA-42 Series Valves

[27041-44](#) . . . . . Hardware Kit for MMA-44 Series Valves

## Rebuild Kits

Convenient rebuild kits are available which contain common maintenance items that may be needed during the life of the valve. Each contains a spool, diamond seal, two pilot seals, two pistons with seals, and spring. Consult factory for 3-position kits.

Part No.	Description
<a href="#">27040-31</a>	3-Way Kit, MMA-31
<a href="#">27040-32</a>	3-Way Kit, MMA-32
<a href="#">27040-33</a>	3-Way Kit, MMA-33
<a href="#">27040-34</a>	3-Way Kit, MMA-34
<a href="#">27040-41</a>	4-Way 2 Pos. Kit, MMA-41
<a href="#">27040-42</a>	4-Way 2 Pos. Kit, MMA-42
<a href="#">27040-43</a>	4-Way 2 Pos. Kit, MMA-43
<a href="#">27040-44</a>	4-Way 2 Pos. Kit, MMA-44